

# Manual Arca

The Settings which are different to the normal Casambi programming are starting under the topic Parameters

## Settings:

If needed change the Code with the Parameterlist.  
(normaly not nessesarry)

## Favorites:

With Favorits it`s possible to change the push bottom to four seperate pushbuttomns.

These Pushbottoms can be konfiguried with the Parameterlist.

(1-8 for G1-8 and a-h for S1-8)

f.Ex. 1a2b → G1 S1 G2 S2

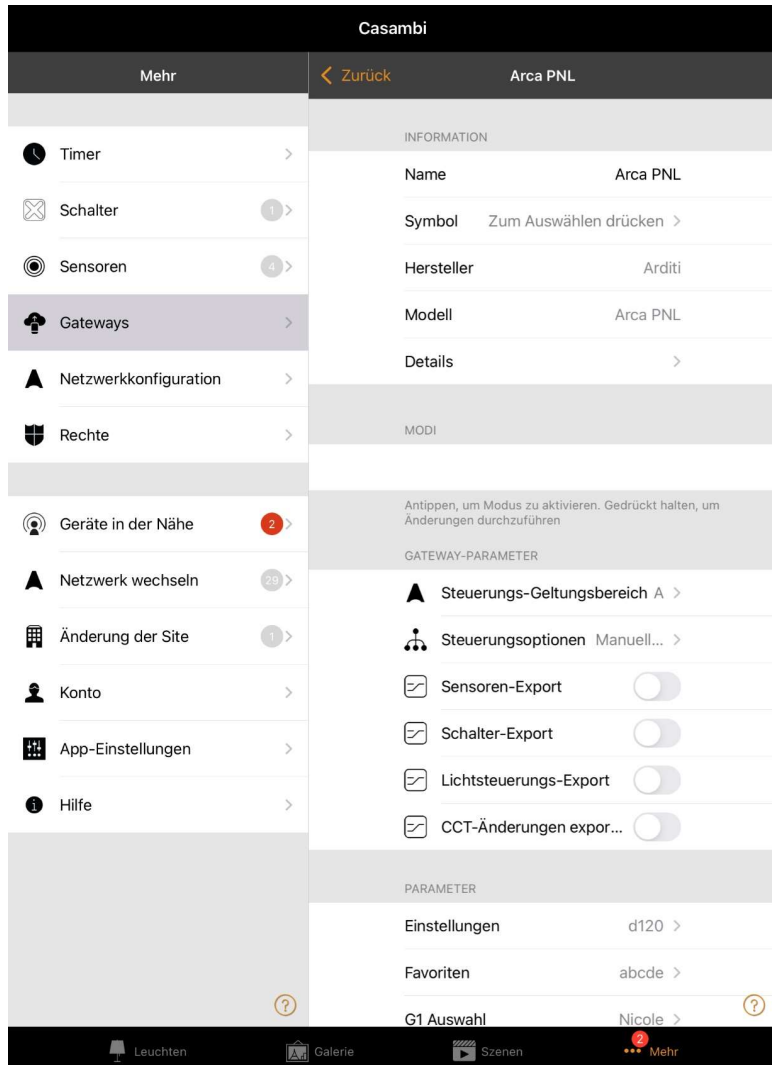



# Manual Arca

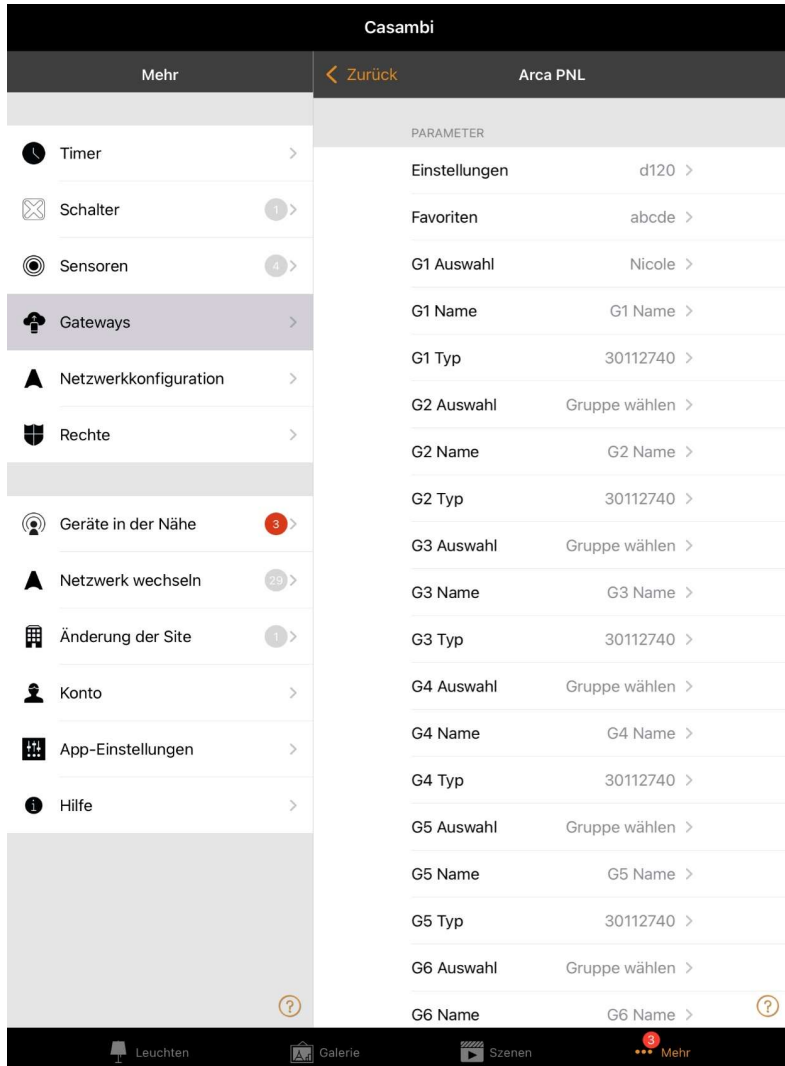

## GX Select:

Select Groups you already created in the Casambi App

## Gx Name:

Give the selected Groupe a name with up to 8 letters.

## Gx Typ:

create a individuel Code for your typ of luminair.

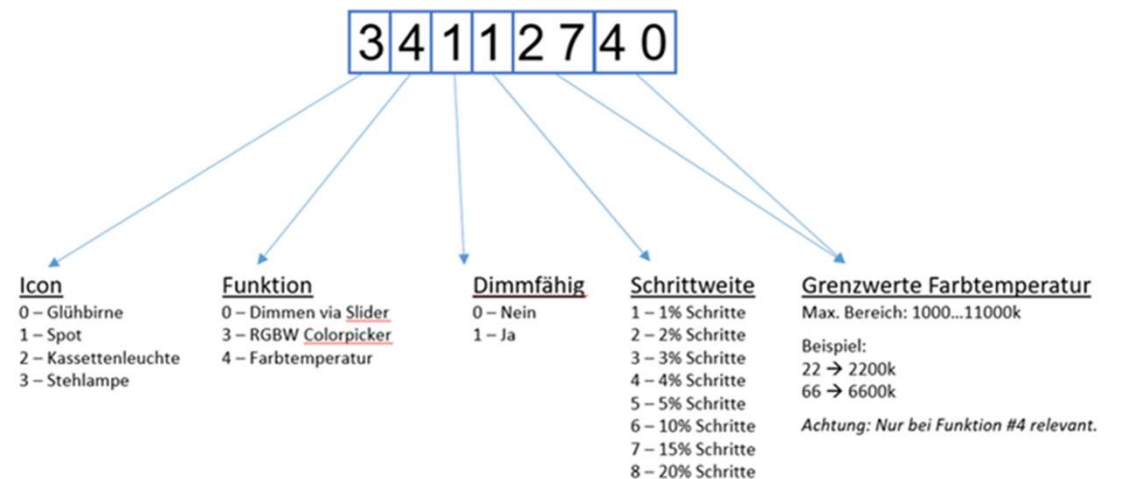



# Manual Arca

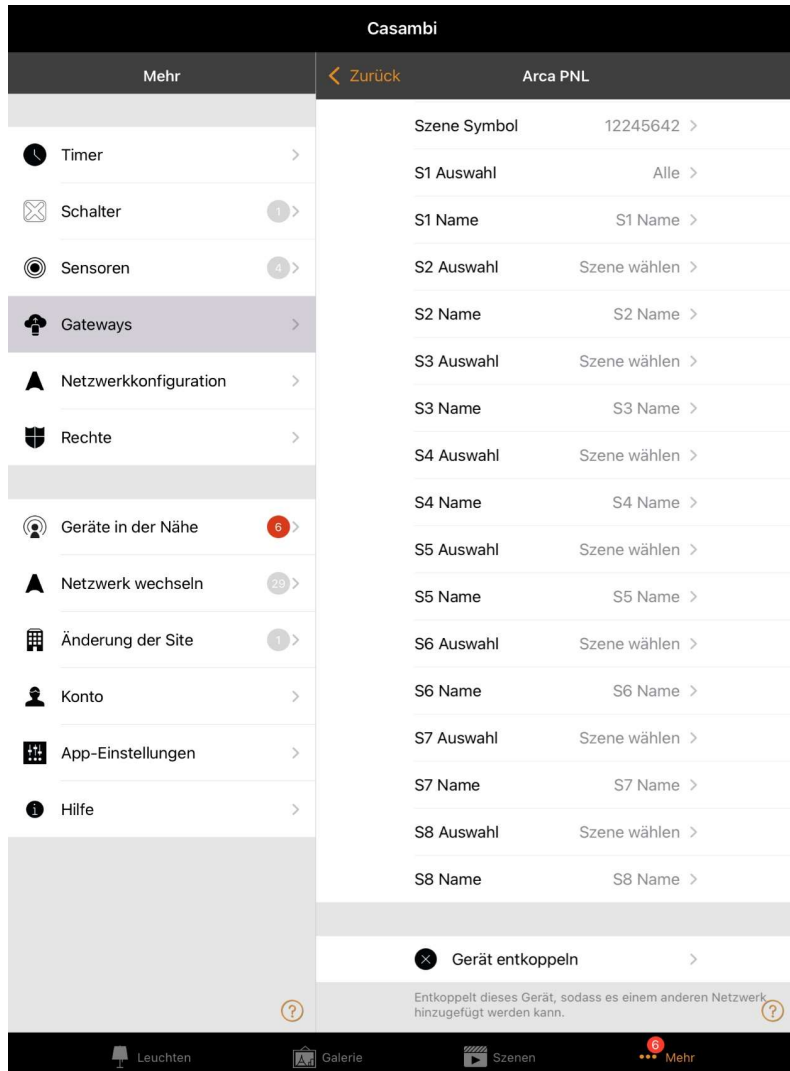

## Scene Symbol:

Select different Numbers from 1 to 8 for different Scene Symboles

## Sx Select:

Select Scenes you previously created, to switch them on and off.

## Sx Name:

Give the selected Groupe a name with up to 8 letters.